



inserts:		page
CD	40 poles + ⊕	43
CDD	72 poles + ⊕	56
CQE	32 poles + ⊕	76
CN	16 poles + ⊕	82
CCE	16 poles + ⊕	90
CNE, CSE	16 poles + ⊕	91
CSS	16 poles + ⊕	100
CMSE	6+2 (aux) poles + ⊕	116
CMCE	6+2 (aux) poles + ⊕	116
CP	6 poles + ⊕	127
CX	6/36 and 12/2 poles + ⊕	130÷131
CX	4/0 and 4/2 poles + ⊕	132
MIXO	4 modules	137÷151

insert centre distance: 77.5 x 27 mm

hoods with 2 levers



hoods with single lever



description	part No.		entry Pg		part No.		entry M	
with levers and gasket, top entry	CHV 16 G	21	MHV 16 G32	32	CHV 16 LG	21	MHV 16 LG32	32
with levers and gasket, top entry, high construction	CAV 16 G	21	MAV 16 G25	25	CAV 16 LG21	21	MAV 16 LG25	25
with levers and gasket, top entry, high construction	CAV 16 G29	29	MAV 16 G32	32	CAV 16 LG29	29	MAV 16 LG32	32
with levers and gasket, top entry, high constr., without adaptor *	CFV 16 G	21	MFV 16 G25	25	CFV 16 LG21	21	MFV 16 LG25	25
with levers and gasket, top entry, high constr., without adaptor *	CFV 16 G29	29	MFV 16 G32	32	CFV 16 LG29	29	MFV 16 LG32	32

\* enclosure without adaptor, threaded on the body, to be used only with a complete cable clamp.

dimensions in mm

CHV G (CAV G) and [CFV G],  
MHV G (MAV G) and [MFV G]

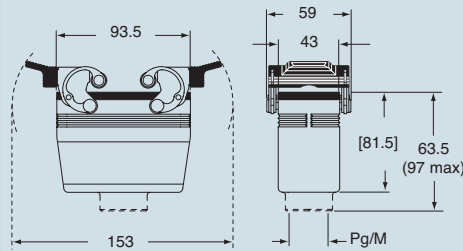

dimensions in mm

CHV LG (CAV LG) and [CFV LG],  
MHV LG (MAV LG) and [MFV LG]

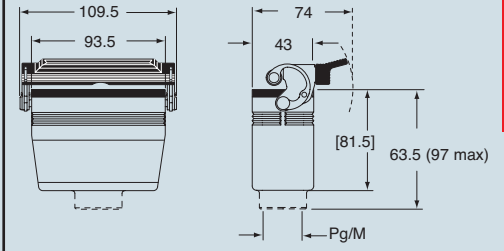

**CALUS**® Type 4/4X/12

dimensions indicated are not binding and may be changed without notice

size 77.27